

# LM-FN CENTER

- ▶ Spanner Type Dead Center
- ▶ RUN OUT 0.00012"/0.0002" or 0.003mm/0.005mm



## LM-FN TYPE

※ Spanner Type

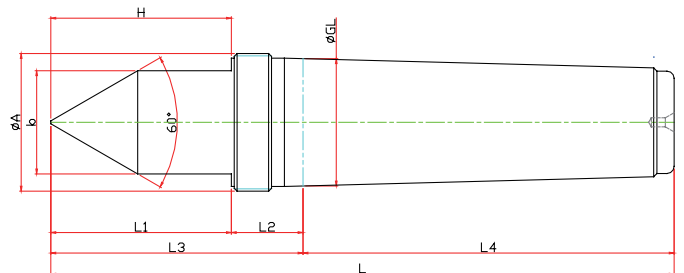

unit:mm/kg

Model	Morse Taper	Dimension									Run out (inch)
		GL	A	b	L1	L2	L3	L4	E	L	
<a href="#">LM-1FN</a>	NO.1	12.065	12.2	10	25	3.5	28.5	53.5	22	82	0,00011811
<a href="#">LM-2FN</a>	NO.2	17.780	18	14	31	5	36	64	30	100	0,00011811
<a href="#">LM-3FN</a>	NO.3	23.825	24	19	39	5	44	81	38	125	0,00011811
<a href="#">LM-4FN</a>	NO.4	31.267	31.6	27	46	6.5	52.5	102.5	50	155	0,00011811
<a href="#">LM-5FN</a>	NO.5	44.399	44.7	36	64	6.5	70.5	129.5	53	200	0,00011811

※SPECIAL sizes or dimensions are available with quick turnaround